

Communications

-Express service

The following companies provide door-to-door express mail and parcel **service**:

DHL: 95380

EMS: 11183

FedEx: 400-886-1888

SF: 95338

-Getting online

Internet access is widely available in residential estates. The monthly charge differs with the Internet bandwidth you need and the choice of service providers. The two major providers are China Unicom and China Telecom.

Internet usage is usually free-of-charge in serviced apartments.

-Phones

DDD and IDD calls

Domestic Direct Dial (DDD) has an area code for each city in China, which you need to dial before the telephone number when making a China long distance call.

For example:

Beijing	北京	(010)
Changchun	长春	(0431)
Changsha	长沙	(0731)
Chengdu	成都	(028)
Chongqing	重庆	(023)
Fuzhou	福州	(0591)
Guangzhou	广州	(020)
Guiyang	贵阳	(0851)
Ha'erbin	哈尔滨	(0451)
Haikou	海口	(0898)
Hangzhou	杭州	(0571)
Hefei	合肥	(0551)
Hohhot	呼和浩特	(0471)
Hongkong	香港	(00852)
Jinan	济南	(0531)
Kunming	昆明	(0871)
Lanzhou	兰州	(0931)
Lhasa	拉萨	(0891)
Macao	澳门	(00853)
Nanchang	南昌	(0791)

Nanjing	南京	(025)
Nanning	南宁	(0771)
Shanghai	上海	(021)
Shenyang	沈阳	(024)
Shijiazhuang	石家庄	(0311)
Taiyuan	太原	(0351)
Tianjin(including TEDA)	天津(含泰达)	(022)
Urumqi	乌鲁木齐	(0991)
Wuhan	武汉	(027)
Xi'an	西安	(029)
Xining	西宁	(0971)
Yinchuan	银川	(0951)
Zhengzhou	郑州	(0371)

International Direct Dial (IDD) in non-serviced accommodations needs a separate application by the landline owner in advance.



Artist: Patric Kühn

Mobile phone

In Tianjin, everybody owns a mobile phone. They are easily purchased on-line, at digital product shops, department stores and major supermarkets. To buy a SIM card, bring your passport to one of the following service providers:



Artist: Amy Yang (杨可言)

China Mobile

Zhōngguó Yídòng

中国移动

Service hotline: 10086

Website: www.10086.cn

Number segments: 135~139, 150~152, 157-159, 178, 182, 184, 187, 188, 195004, 195823, 195828 and 195829.

China Telecom

Zhōngguó Diànxìn

中国电信

Service hotline: 10000

Website: www.189.cn

Number segments: 133, 153, 173, 177, 180, 181, 189, 191 and 199.

China Unicom

Zhōngguó Liántōng

中国联通

Service hotline: 10010

Website: www.10010.com

Number segments: 130~132, 155, 156, 166, 175, 176, 185 and 186.

*An additional subscription is needed if you require roaming **service** on your Chinese-SIM-card mobile phone. Ensure that your mobile phone account balance has more than RMB 200. You can subscribe to roaming by dialing your mobile service provider's service hotline, as listed above. You may opt to subscribe for limited or open period roaming. Roaming service terminates when your phone account balance is used up.*

Mobile phone bills payment

*You may either pay the phone bill month by month online, or keep a high balance in your mobile phone account. To check the outstanding amount, you can use your service provider's official account or dial the service hotline. Overdue outstanding bill charges may render your **service** to be terminated, including your Internet access, if it is bound together with your mobile phone.*

Recommended APPs



WeChat(微信 Wēixin)

Download and install WeChat (微信 Wēixin) on your smartphone. This is a “must” for living in China. You can use it for making free phone calls and video calls; for sending and receiving texts, voice messages, pictures and videos; for having group chats and meetings; for exchanging locations and doing GPS navigation. What’s more important for WeChat nowadays is that you can use WeChat to make payments by binding it with your bank account. Cash, wallet and credit cards are all out of date!



Artist: Timmy Yang (杨齐然)

How to use “WeChat” (微信)

Download

Input “WeChat” (微信 Wēixìn) on your App Store, Myapp, or GetApps. (as in picture 1)



Registration

The following steps will show you how to register,

- Fill in the personal information required (as in picture 2)
- Tick “我已阅读并同意” (I have read it and agreed...) and then click “下一步” (next step). (as in picture 3)
- Click “开始” start to verify identification. (as in picture 4)
- Slide the puzzle to complete. (as in picture 5)



Setting up language

Click the “little guy icon” (as in picture 6) on the bottom right corner of the screen and then go through the four steps to set it up.

设置(as in picture 7) → 通用(as in picture 8) → 多语言(as in picture 9) → English (as in picture 10)

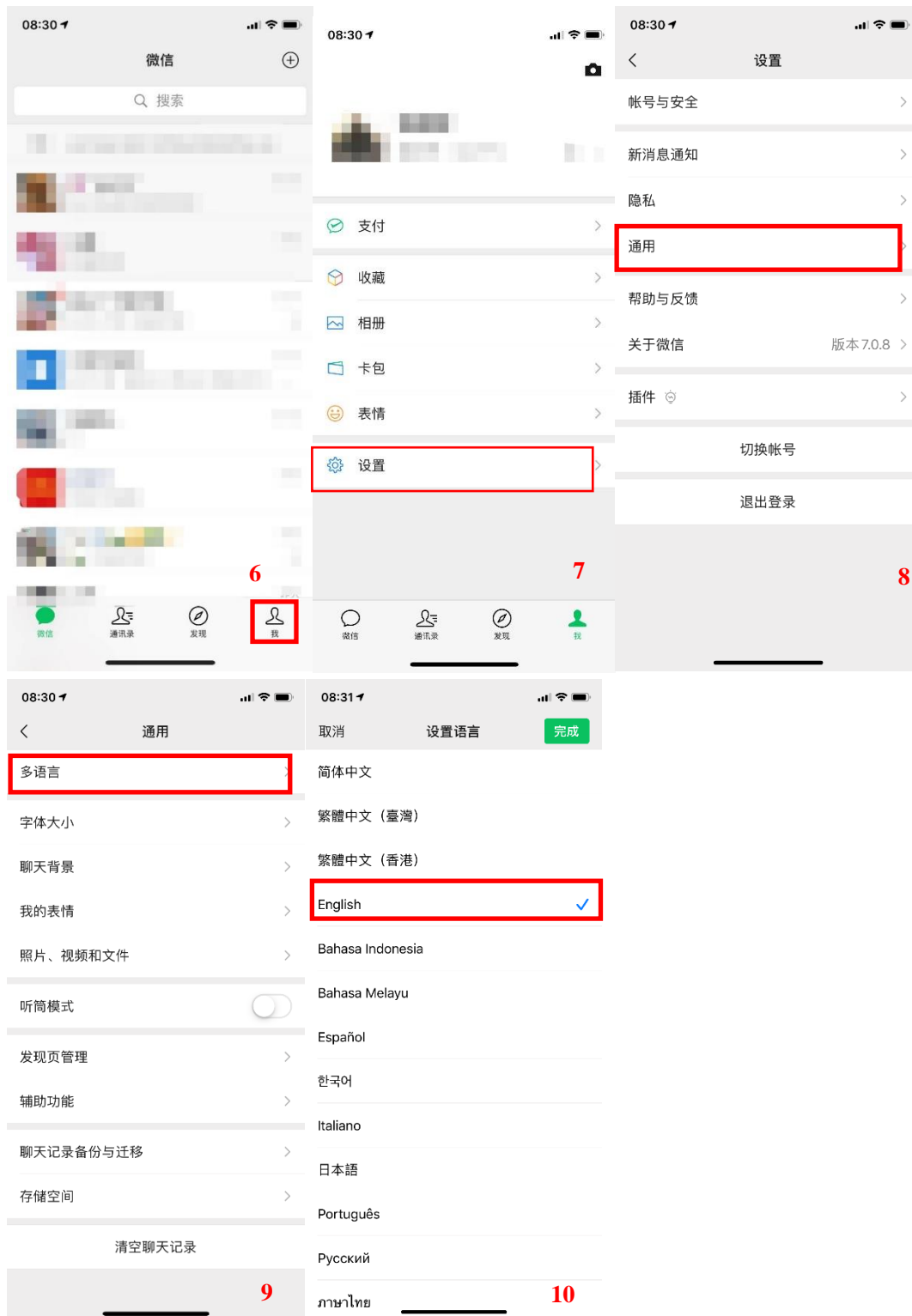

Social Platform

-Adding contacts by inputting WeChat ID or mobile number of your contact.

- a. Click the “Upper right corner +” (as in picture 11)
- b. Click “Add Contacts” (as in picture 12)
- c. Input the WeChat ID or mobile phone number of your contact. (as in picture 13)
- d. Click “Add” (as in picture 14)

- e. Input your greeting to your contact. (as in picture 15)
- g. Once your contact **accept** your request, you can start chatting.



Artist: Elena Milovanovic

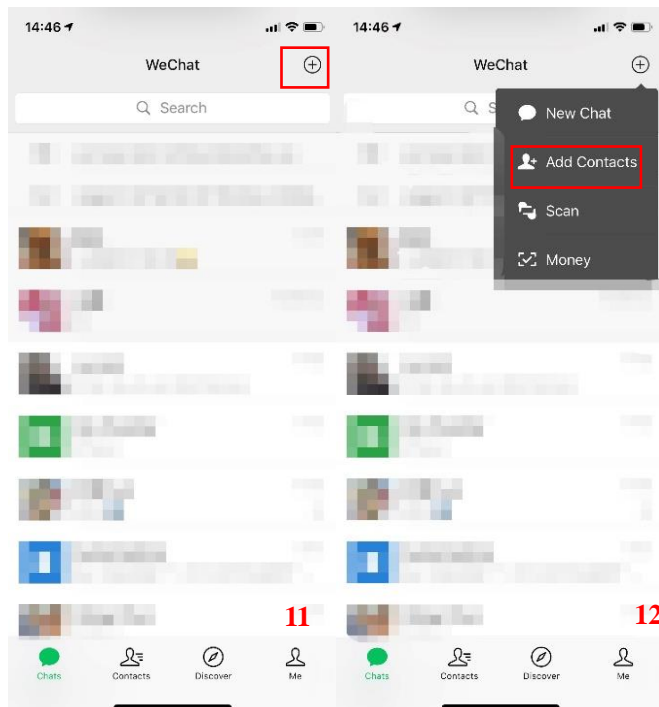

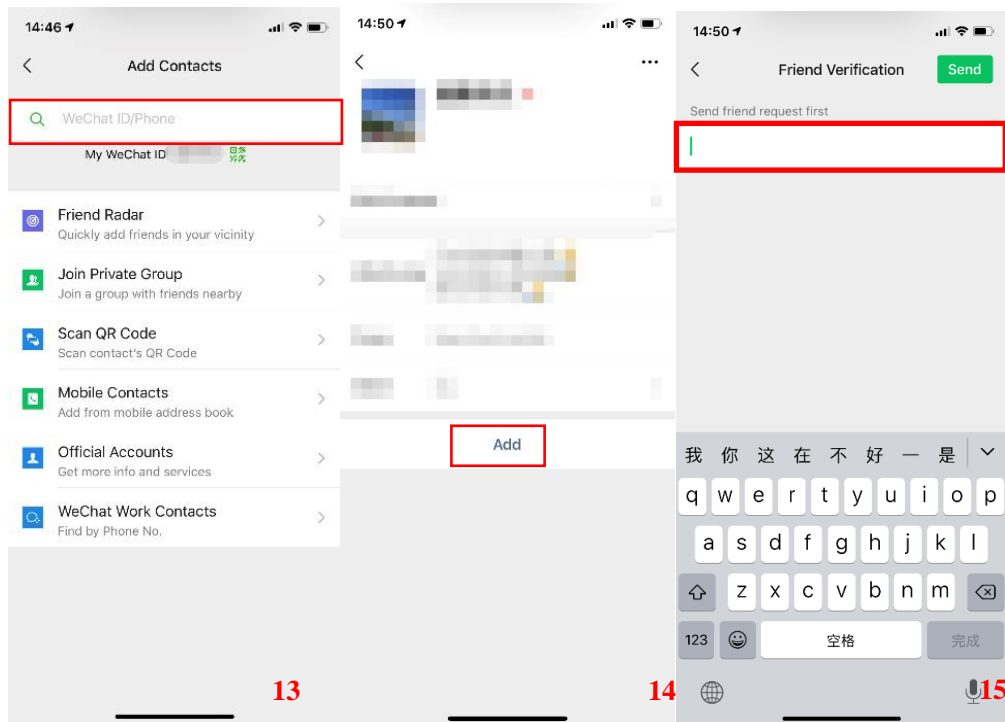

-Adding contacts by scanning a QR Code.

- Click the 'little guy icon' (as in picture 16) on the bottom right corner of the screen.
- Click 'My QR Code' (as in picture 17)
- Show your QR Code to your contacts and let them add you. (as in picture 18)
- Vice versa, you can scan their QR Code (as in picture 19 and 20).

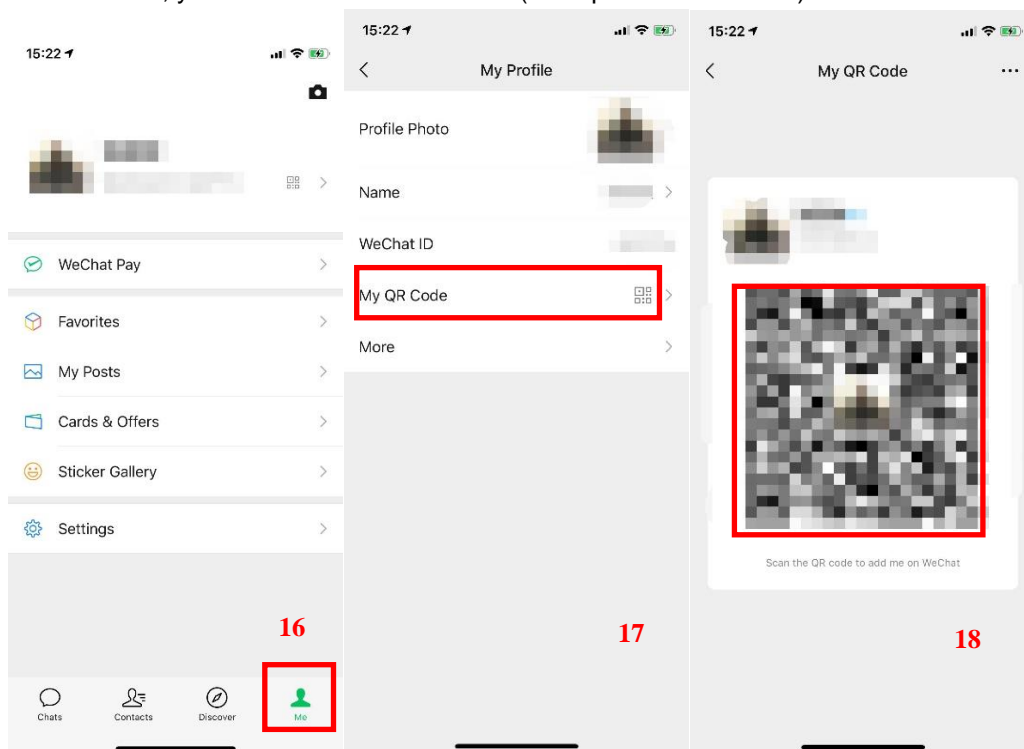

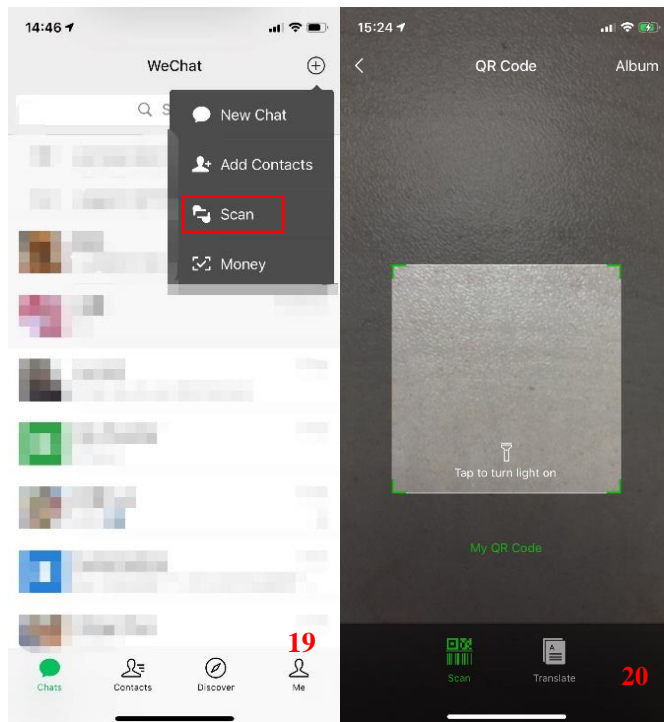

-Chat privately.

- Click the 'Contacts' (as in picture 21) on the bottom of the screen.
- Find the contact you require within the address list. (as in picture 22)
- Click his/her name and chat with him/her (as in picture 23)

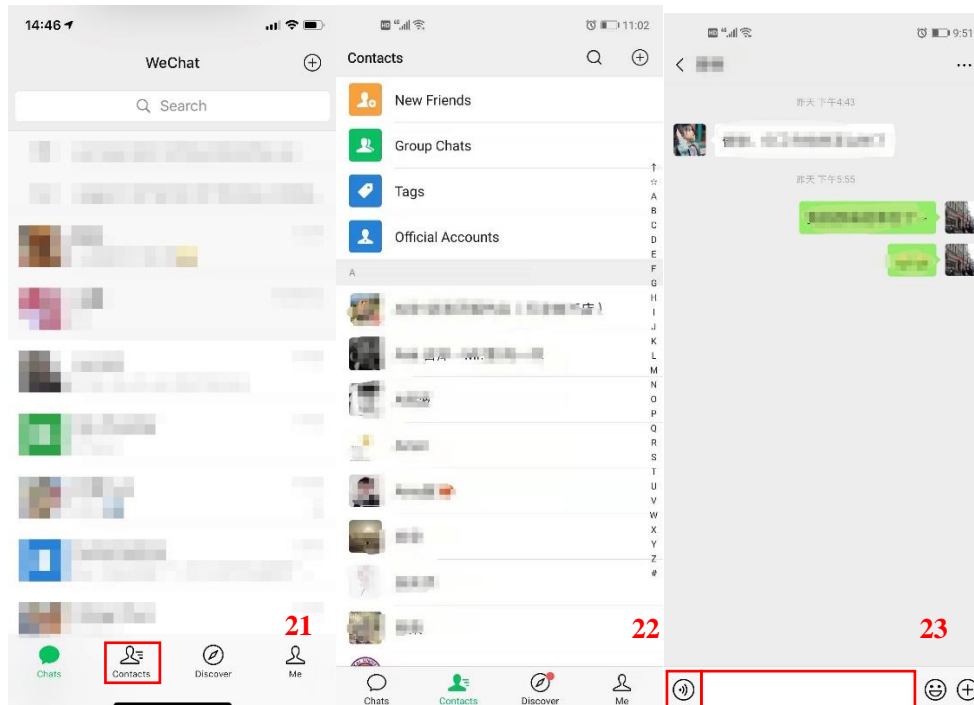

-Chat in a group, up to 500 people.

- Click "New Chat" (as in picture 24)
- Find the contact in the address list. (as in picture 25)
- Click his/her name and add him/her. (as in picture 26)

- d. Click “OK” (as in picture 27)
- e. Group Chat is done. (as in picture 28)

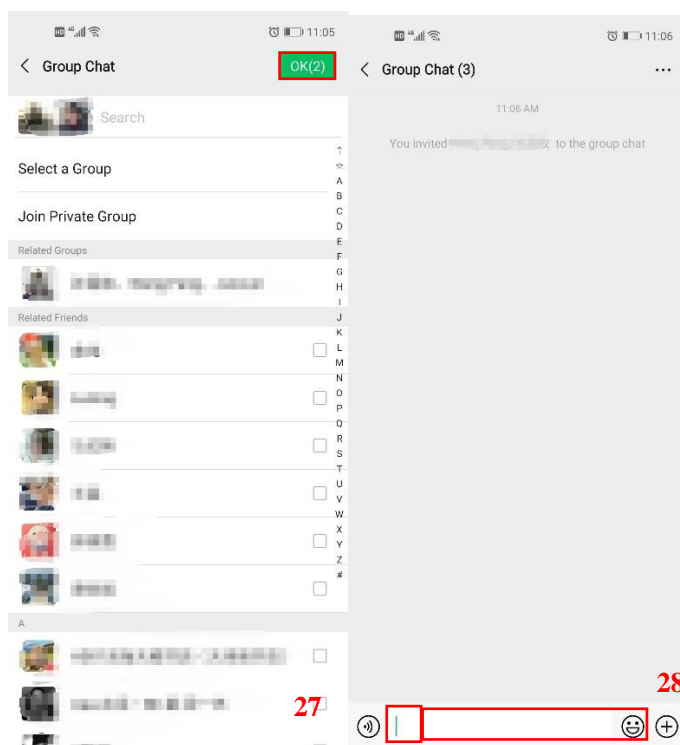
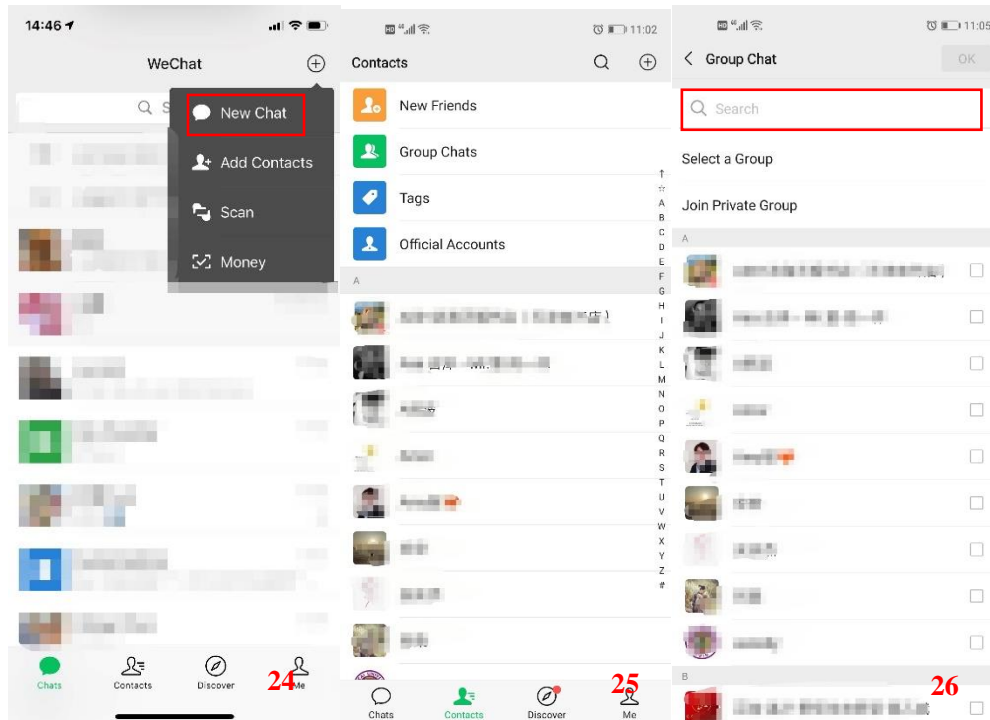

Mobile pay by WeChat

-Binding bank card

- a. Click “WeChat Pay” (as in picture 29)

- b. Click “Wallet” (as in picture 30)
- c. Click “Cards” (as in picture 31)
- d. Add your bank card (as in picture 32)
- e. Input a password, this is not your bank card pin code, but a password for WeChat payment only. (as in picture 33)
- f. Input your name and your bank card number, and then click the “Next”. (as in picture 34)
- g. Input your phone number which is linked to your bank account. (as in picture 35)
- h. Input the verification code received by your phone. (as in picture 36)
- j. Done! You can use WeChat pay now. (as in picture 37)

Note:

To properly bind the card to your WeChat account, all the personal information must be the same as in your bank document.

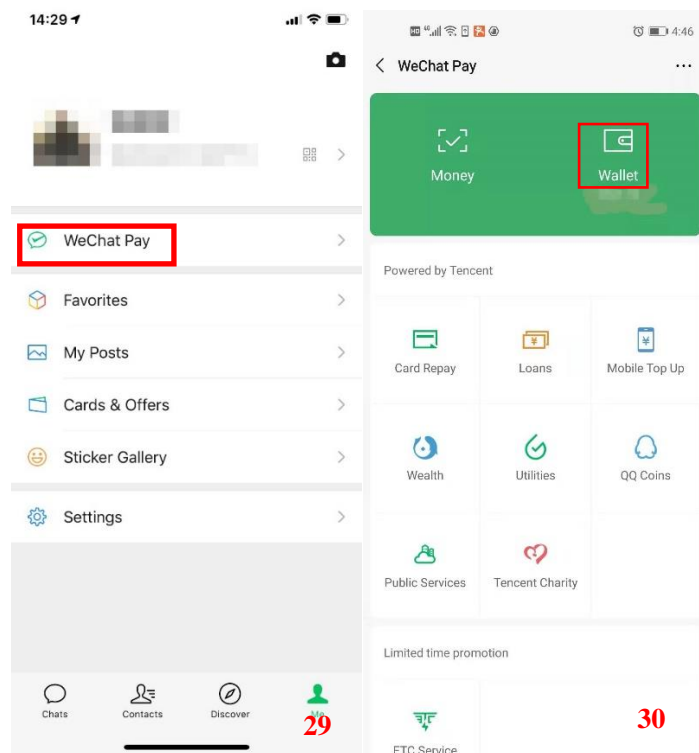

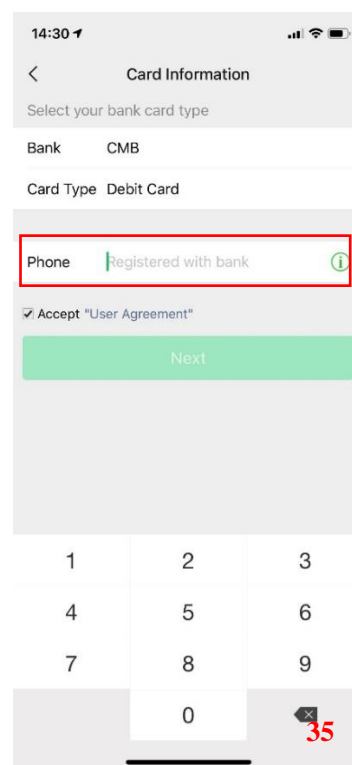
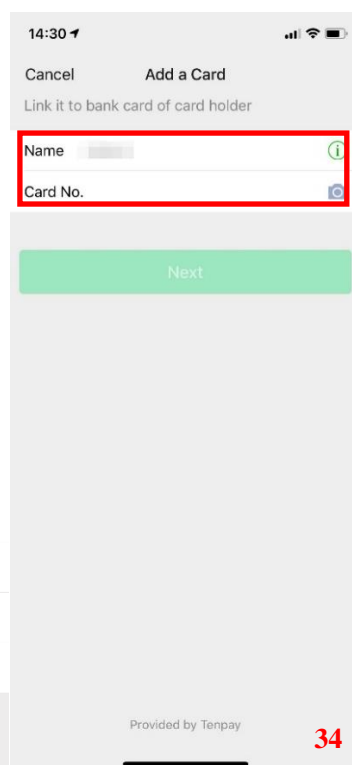
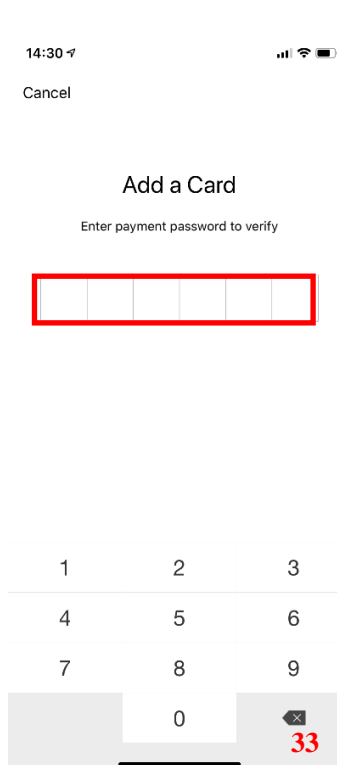
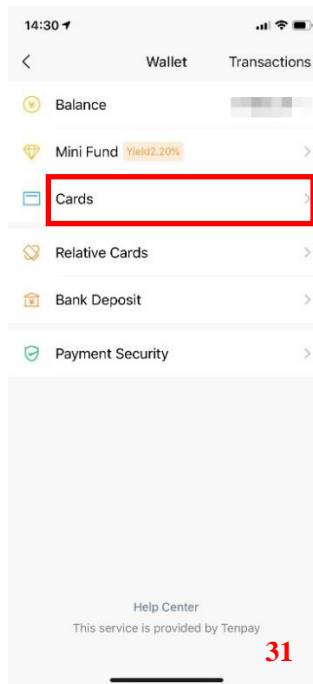

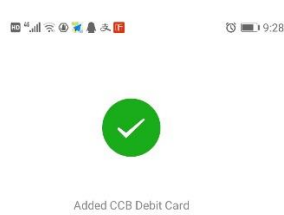
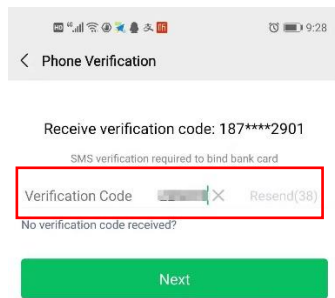

37

Note:

WeChat wallet verification:

You need to make wallet verification when you pay via WeChat for the first time.

The following steps will show you how to verify,

-When you pay for the first time, you will receive this message. Please click "View Details" (as in picture 38)

-You need to fill in your passport number, mobile phone number, and submit a photo of your passport and **yourself**. (as in picture 39)

-You can use your wallet after a few seconds.

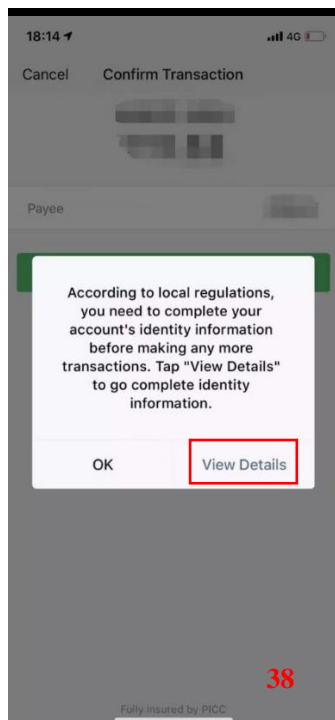

38

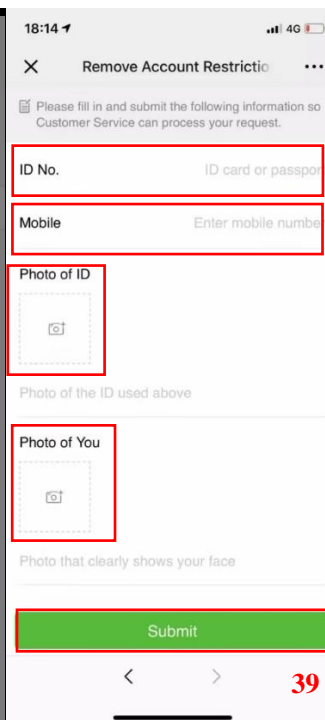

39

-Pay via WeChat

a. Pay at shops/restaurants etc.

-Click “Money” (as in picture 40) and show your QR Code to pay. (as in picture 41)

-Or, click the “WeChat Pay” (as in picture 42) and then click the “Money” (as in picture 43), then you will get your QR Code. (as in picture 41)

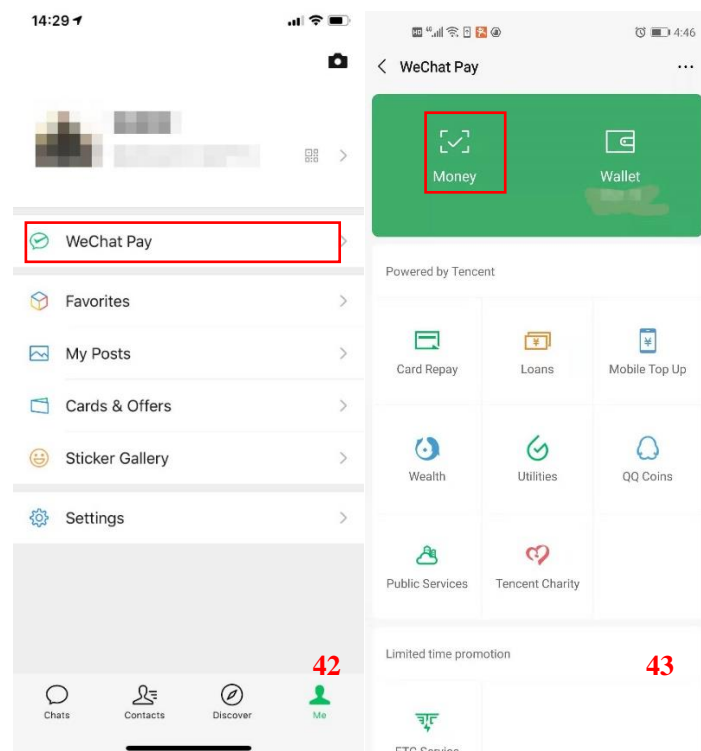
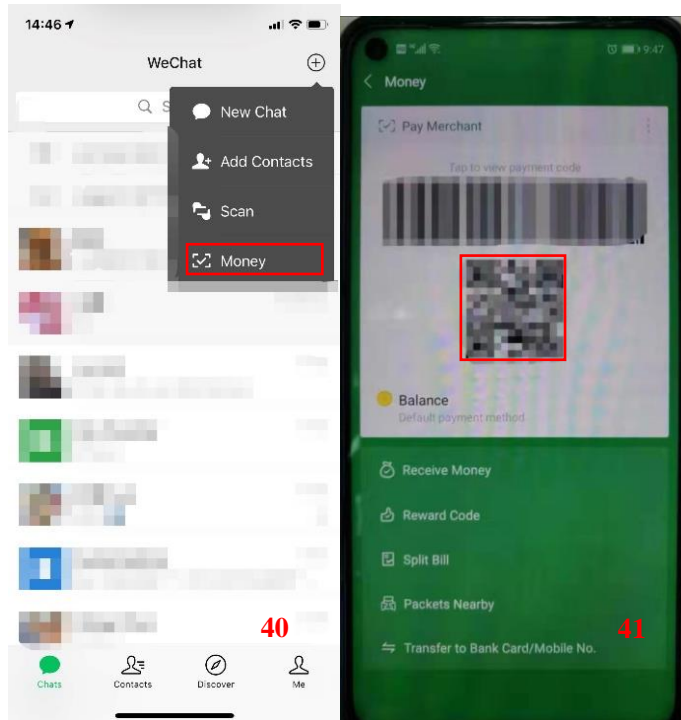

b. Pay phone bill

-Click the “WeChat Pay”. (as in picture 44)

- Click “Mobile Top Up”. (as in picture 45)
- Input your phone number and select the amount to top up. (as in picture 46)
- Input your WeChat password (as in picture 47)
- Payment done (as in picture 48)

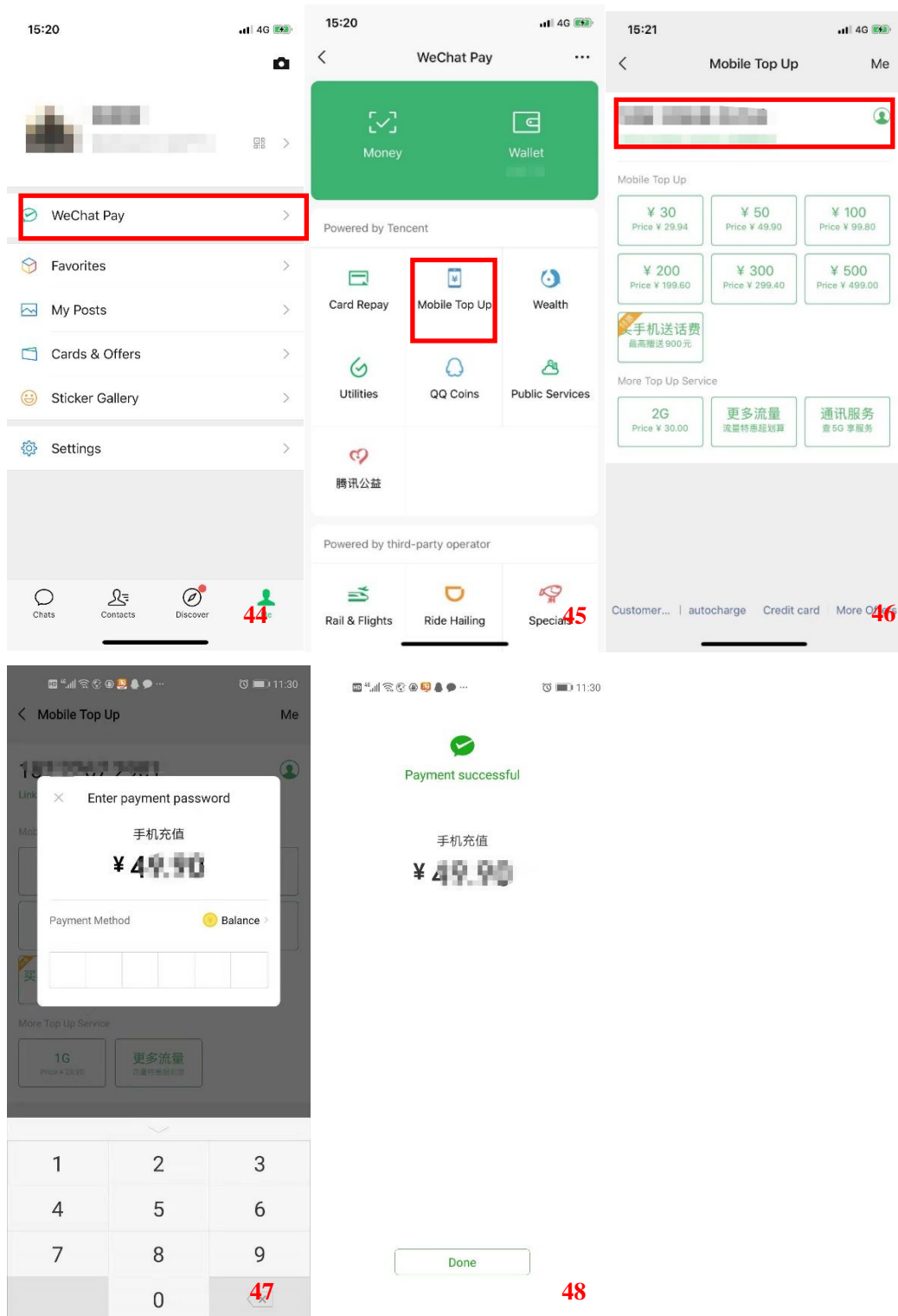

c. Pay electricity fee

- Click “WeChat Pay” (as in picture 49)

- Click “Utilities” (as in picture 50)
- Click “electricity” (as in picture 51)
- Click “天津市电费” (as in picture 52)
- Click “缴费户号” (as in picture 53)
- Input “缴费户号”10-digit electricity account number and “手机号” mobile number. (as in picture 54)
- Input the name of your apartment and tick “我已阅读并同意” (I have read it and agreed...) and then click “下一步” (next step). (as in picture 56)
- Input how much you want to pay, and then click “立即缴费” (pay at once). (as in picture 57)
- Input your WeChat password. (as in picture 58)
- Payment done. (as in picture 59)

Note:

To check the electricity company name and 10-digit electricity account number, please refer to 购电证 electricity book. (as in picture 55)

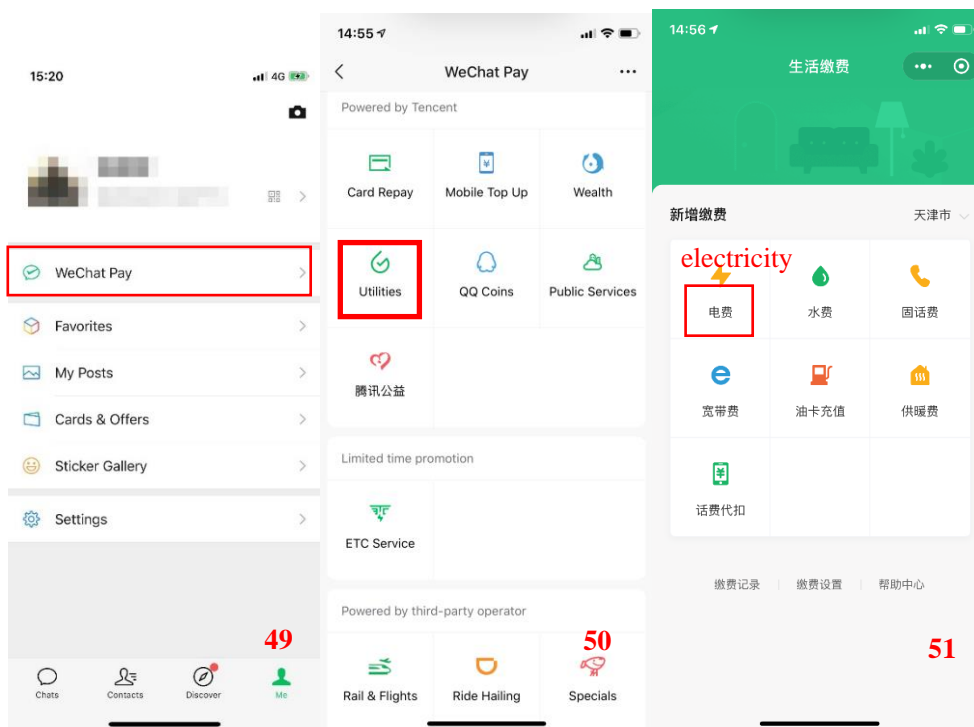



52



53



Input 10-digit account number

Input your mobile number



54

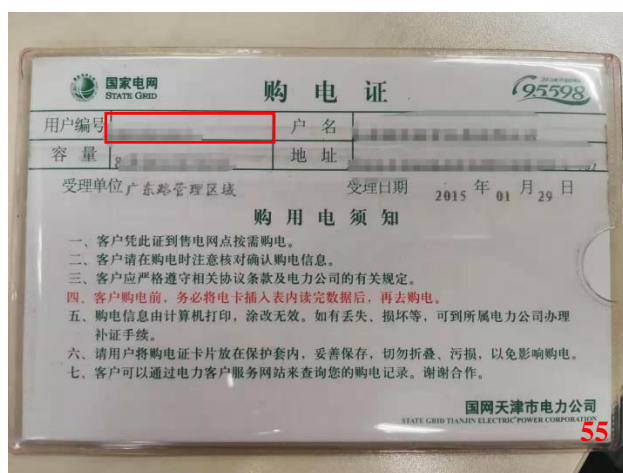

55

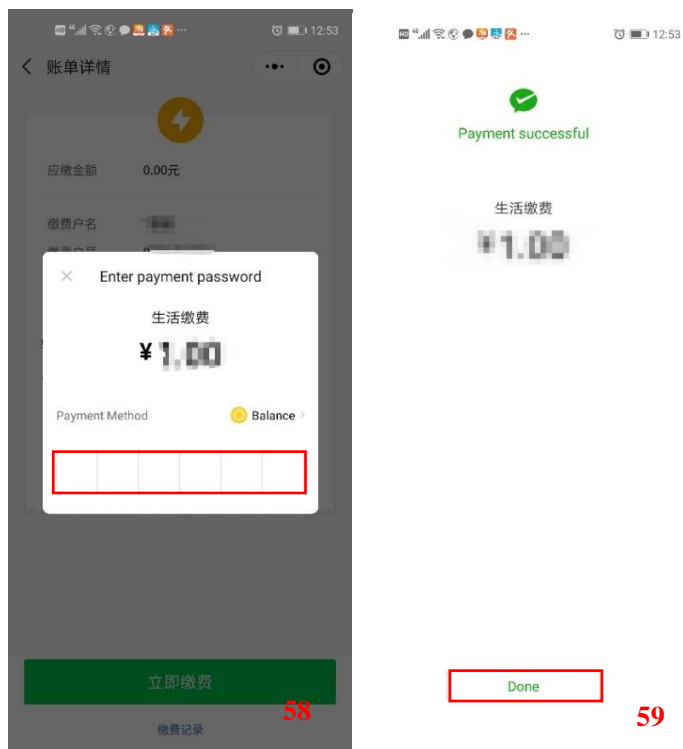
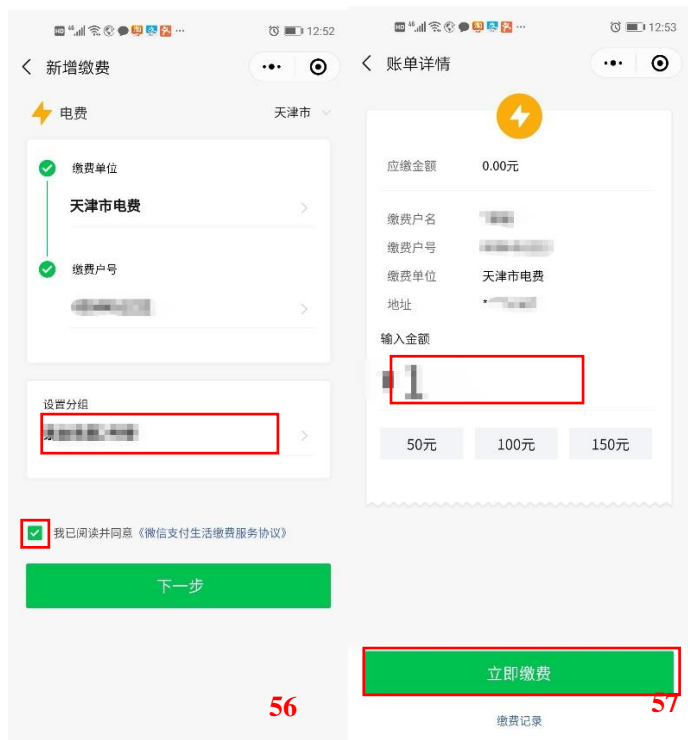

d. Send/receive money to/from your friends.

-Click “+” (as in picture 60)

-Click “Red Packet” (as in picture 61).

-Input the amount you want to send, and you can write your best wishes. Then click the “Prepare Red Packet” (as in picture 62)

-Input your WeChat password. (as in picture 63)

-Send done. (as in picture 64)

- When your friend clicks the Red Packet, the money will get into his/her wallet. (as in picture 65)
- Vice versa, you can receive his/her money.

Note:

To send Red Packet, maximum amount is RMB 200.

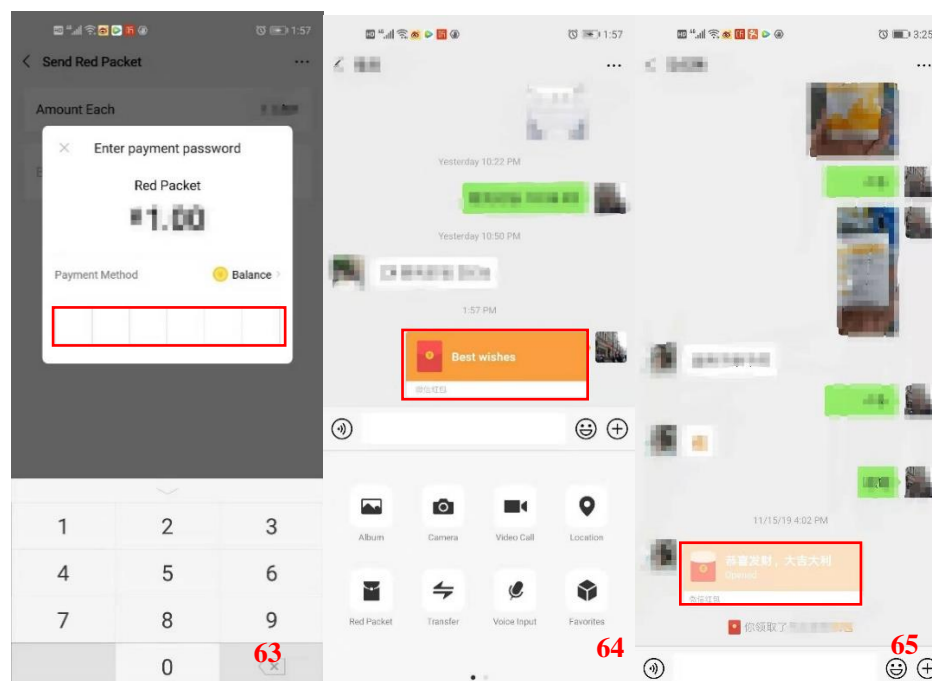
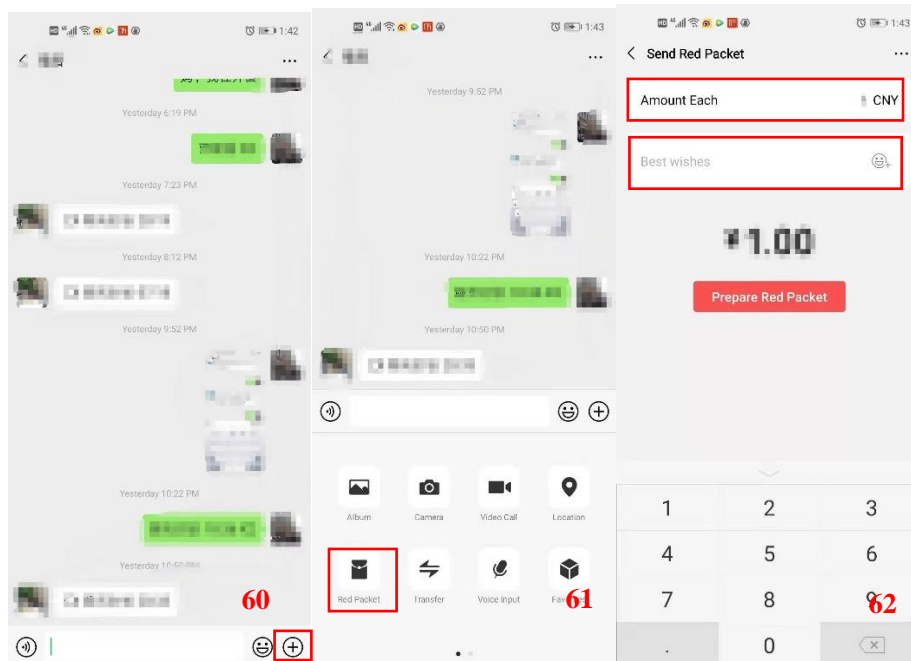

e. Transfer money, each withdrawal of more than RMB 1000 is charged a 0.1% fee.

- Click "Transfer" (as in picture 66)
- Input the amount you want to transfer (as in picture 67)
- Input your WeChat password (as in picture 68)
- Send done (as in picture 69)

- Wait for your friend to accept. When your friend clicks the “WeChat transfer”, the money will get into his/her wallet. (as in picture 70)
- Vice versa, you can receive his/her money.

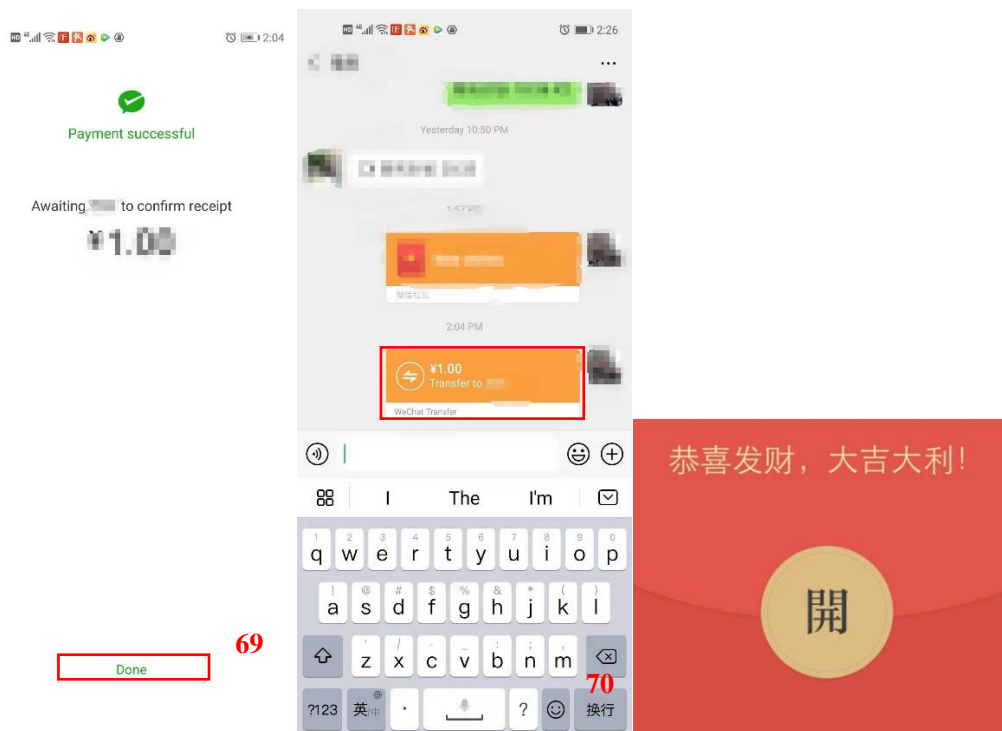
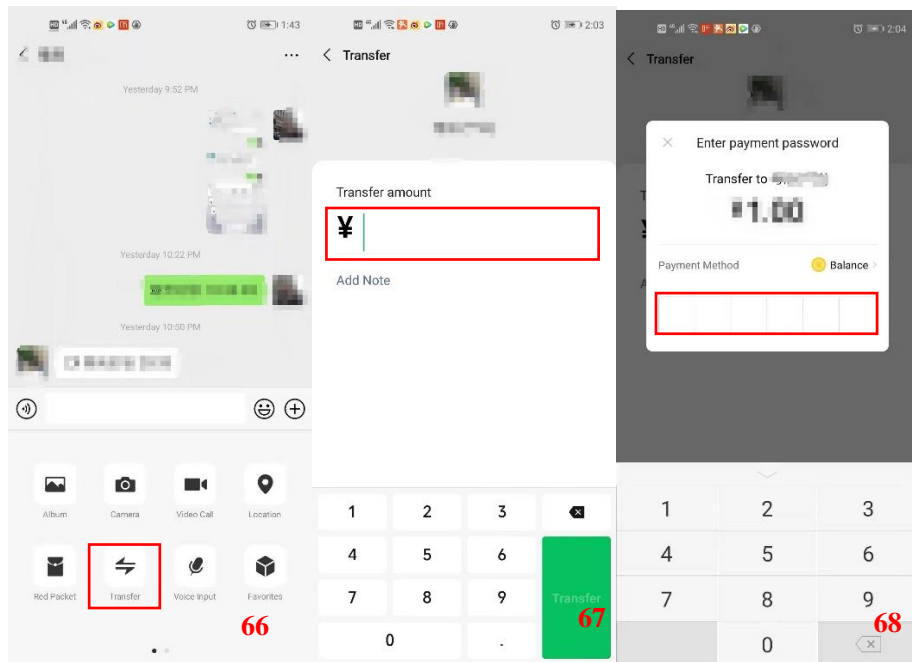

f. Apply for Health Code

Please refer to [P101](#), the Medical Service (City Section), for how to apply for Health Code on WeChat.



Other useful APPs 参考书 P44-P45 页

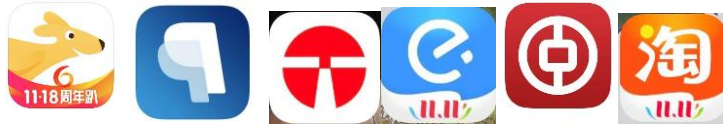

Meituan	Paypal	Tianjin Subway	Eleme	ICBC	Taobao
---------	--------	----------------	-------	------	--------



Please refer to [P29](#) about how to download and use WeChat, [P222](#) about Tianjin Subway, [P209](#) about Alipay, [P225](#) about DiDi.

-Postal service

Post offices

To post a parcel abroad, customs inspection is compulsory. Do not seal it until you receive the “stamp of approval” from customs inspection, on the parcel. There is a value limit of RMB 800-1000 for a parcel posted abroad.

To post a parcel abroad, bring your passport and cash in person.

Binjiangdao Post Office

Bīnjiāngdào Yóujú

滨江道邮局

Add: No. 125, Binjiang Dao, Heping Dist.

Héping Qū Bīnjiāng Dào 125 hào

和平区滨江道 125 号

Tel: 27116026

Hours: Mon-Sun: 09:00-17:30

Jinnan Post Office

Jīnnán Yóujú

津南邮局

Add: No. 176, Jingu Lu, Jinnan Dist.

Jīnnán Qū Jīngū Lù 176 hào

津南区津沽路 176 号

Tel: 88914383

Hours: Mon-Sun: 09:00-17:30



Artist: Marat EEBERDYEV

Liqizhuang Post Office

Lǐqīzhuāng Yóujú

李七庄邮局

Add: Commercial Section, Building 1, Aoxiangyuan, No.150, Weijin Nanlu, Nankai Dist.

Nánkāi Qū Wèijīn Nánlù 150 hào Àoxiángyuán 1 hào lóu dīshāng

南开区卫津南路 150 号奥翔园 1 号楼底商

Tel: 23382410

Hours: Mon-Sun: 09:00-17:30

Meijiang Post Office

Méijiāng Yóujú

梅江邮局

Add: No. 107, Meijiang Dao, Meijiang Residential Area, Hexi Dist.

Héxī Qū Méijiāng Jūzhùqū Méijiāng Dào 107 hào

河西区梅江居住区梅江道 107 号

Tel: 88360379

Hours: Mon-Sun: 09:00-17:00

Dalong Post Office

Dàlóng Yóujú

大龙邮局

Add: No. 101, Changsha Lu, Heping Dist.

Héping Qū Chángshā Lù 101 hào

和平区长沙路 101 号

Tel: 23305181

Hours: Mon-Sun: 09:00-17:30

The very first stamp in China was issued at this post office in 1878.



Tianjin Railway Station Post Office

Dōngzhàn Yóujú

东站邮局

Add: No. 86, Haihe Donglu, Hedong Dist. (beside the Tianjin Railway Station)

Hédōng Qū Hǎihé Dōnglù 86 hào (Tiānjīn Zhàn páng)

河东区海河东路 86 号（天津站旁）

Tel: 24213296, 24217528

Hours: Mon-Fri: 09:00-17:00

This is the headquarters of the post offices in Tianjin. It can provide all the international postal service, which some branch offices may not be able to provide.

Tiyuanbei Post Office

Tǐyuànběi Yóujú

体院北邮局

Add: No. 6, Huanhu Zhongdao, Hexi Dist.

Héxī Qū Huánhú Zhōngdào 6 hào

河西区环湖中道 6 号
Tel: 23554669
Hours: Mon-Sun: 09:00-17:30



Artist: *LIU Yan (刘岩)*

Write a country's name in Chinese

To expedite mails and parcels sorting and delivery, ensure that you have written the destination country name in Chinese besides other languages. Here are some examples:

Argentina	阿根廷		Iran	伊朗		Portugal	葡萄牙
Australia	澳大利亚		Ireland	爱尔兰		Saudi Arabia	沙特阿拉伯
Austria	奥地利		Israel	以色列		Singapore	新加坡
Belgium	比利时		Italy	意大利		South Africa	南非
Brazil	巴西		Japan	日本		Spain	西班牙
Canada	加拿大		Korea	韩国		Sri Lanka	斯里兰卡
Chile	智利		Kenya	肯尼亚		Sweden	瑞典
Columbia	哥伦比亚		Malaysia	马来西亚		Switzerland	瑞士
Costa Rica	哥斯达黎加		Mexico	墨西哥		Thailand	泰国
Czech	捷克		Mongolia	蒙古		Turkey	土耳其
Denmark	丹麦		Nepal	尼泊尔		UK	英国
Egypt	埃及		Netherlands	荷兰		Ukraine	乌克兰
Finland	芬兰		New Zealand	新西兰		United Arab Emirates	阿联酋
France	法国		Nigeria	尼日利亚		USA	美国
Germany	德国		Norway	挪威		Venezuela	委内瑞拉
Greece	希腊		Pakistan	巴基斯坦		Vietnam	越南
India	印度		Philippine	菲律宾			
Indonesia	印度尼西亚		Poland	波兰			



Artist: Da Hyeon Lee